

# POLE GUN adapter Parts

2012.07.11 rev2

3600 psi (250 bar, 25 MPa) Maximum Working Pressure

PAT NO. 10-2012-0029690

MODEL

**APGA-001 7/8" – 7/8"**

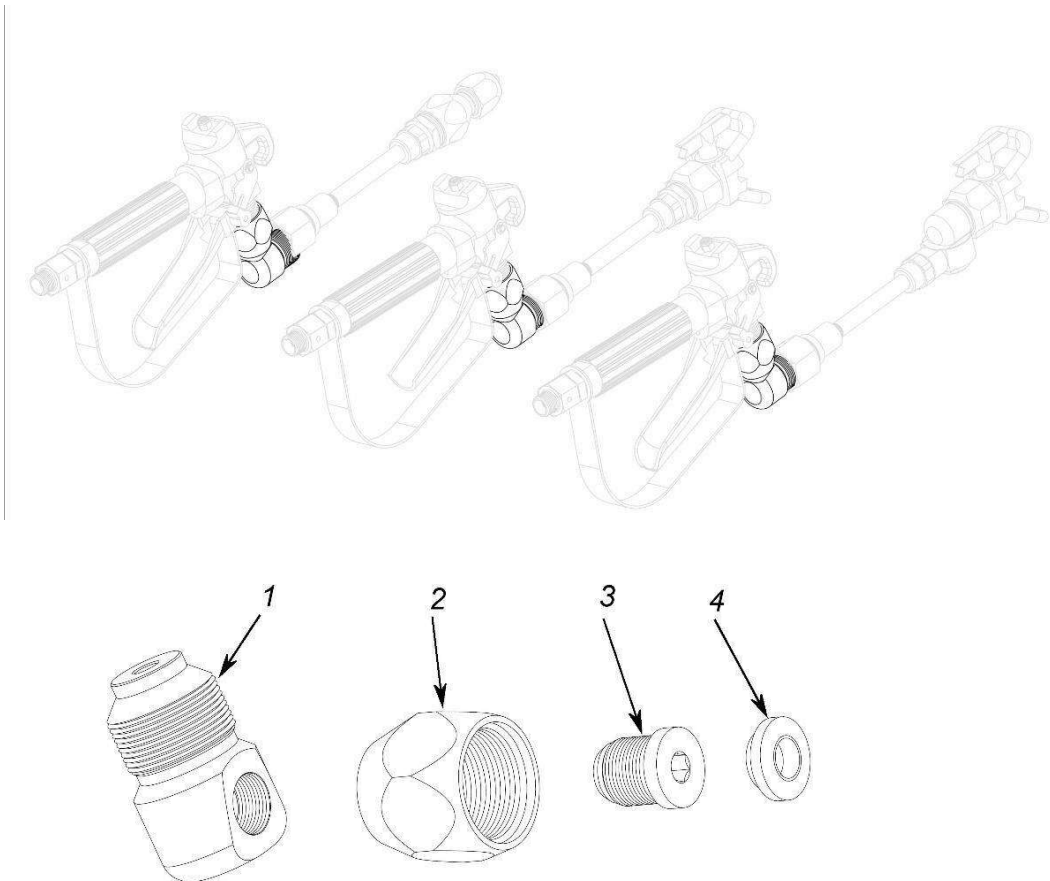

part

No	PART NO	Description		Qty
1	APGA-001	BODY		1
2	APGA-002	NUT	G830-600-3	1
3	APGA-003	BOLT	G830-600-2	1
4	APGA-004	GASKET		1



**DSTech Co., LTD.**

#1461-2, Songjung-dong, Gangseo-gu,  
Busan, Korea (618-817)

Tel: 82-51-207-8006

Fax: 82-51-207-8831

www.dstpump.com

# Gun Extension Pole and Accessories

2015.09.21 rev3

<b>AGEB-150</b>	<b>150mm</b>	<b>POLE</b>
<b>AGEB-300</b>	<b>300mm</b>	<b>POLE</b>
<b>AGEB-500</b>	<b>500mm</b>	<b>POLE</b>
<b>AGEB-700</b>	<b>700mm</b>	<b>POLE</b>
<b>AGEB-1000</b>	<b>1000mm</b>	<b>POLE</b>

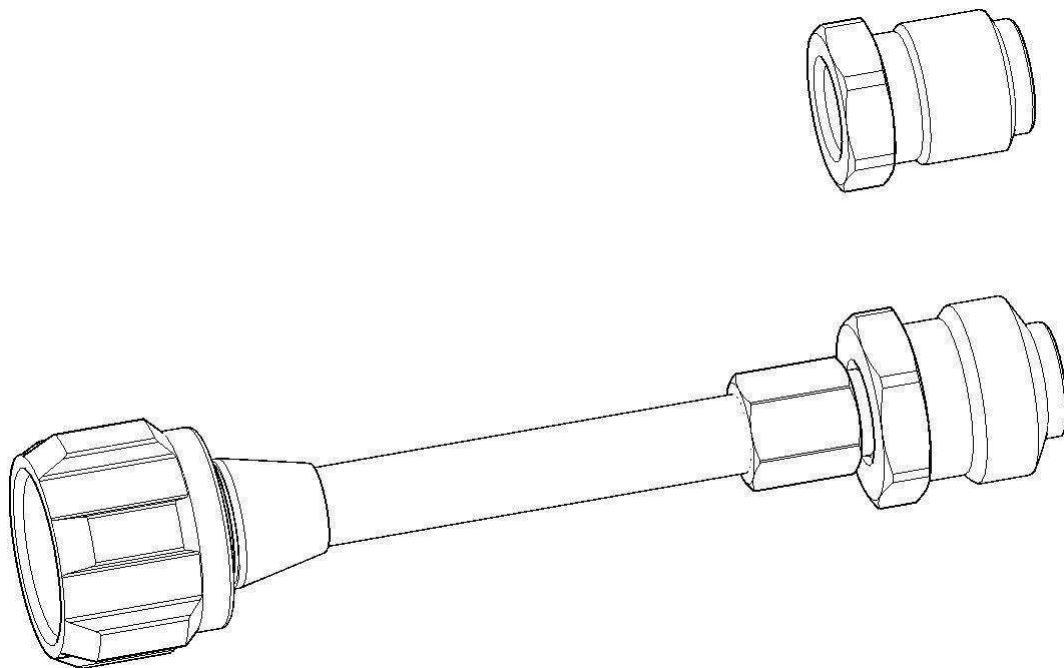

**DSTech Co., LTD.**  
#1461-2, Songjung-dong, Gangseo-gu,  
Busan, Korea (618-817)  
Tel: 82-51-207-8006  
Fax: 82-51-207-8831  
[www.dstpump.com](http://www.dstpump.com)

**S/W Tip GUARD**

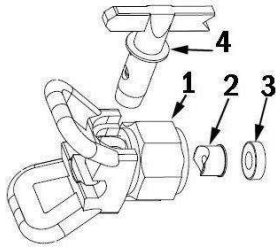

No	D Code	G Code	Description
1	AST0-001	237-859	7/8" S/W TIP GUARD
	AST0-002	237-858	11/16"S/W TIP GUARD
2	AST0-003		SADDLE
3	AST0-004		PACKING
4	AST0-XXX		S/W TIP

**GUN Adapter**

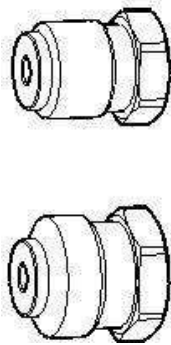

D Code	G Code	Description (IN)x(OUT)
E110-006		GUN ADAPTER (7/8")x (1/2-20)
E110-007		GUN ADAPTER (11/16")x (1/2-20)

**Turn Spary Nozzle**

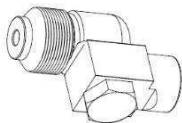

D Part	G Part	Description Inlet x Outlet
AGES-001	235-486	1/2"-20unf x 7/8"-14unc

**Extension Pol**

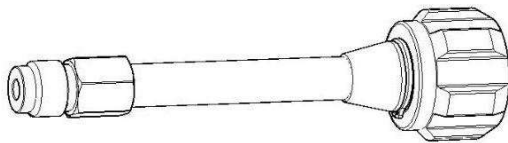

D Part	G Part	Description Inlet x Outlet
AGEB-150		150mm 7/8"-14unf x 1/2"-20unf
AGEB-300		300mm 7/8"-14unf x 1/2"-20unf
AGEB-500		500mm 7/8"-14unf x 1/2"-20unf
AGEB-700		700mm 7/8"-14unf x 1/2"-20unf
AGEB-1000		1000mm 7/8"-14unf x 1/2"-20unf

**Flat Tip HOUSING NUT**

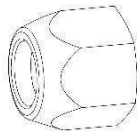

D Part	G Part	Description
G830-001	220-255	TIP FILLET HOUSING NUT

**Tip Filter Housing**

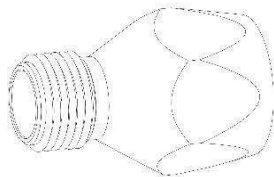

D Part	G Part	Description Inlet x Outlet
G830-004	164-120	7/8"-14unf x 11/16"-16unc

# **Gun Extension Pole and Accessories**

2015.09.21 rev3

<b>AGEB-K01</b>	<b>300mm</b>	<b>POLE</b>
<b>AGEB-K02</b>	<b>500mm</b>	<b>POLE</b>
<b>AGEB-K03</b>	<b>700mm</b>	<b>POLE</b>
<b>AGEB-K04</b>	<b>1000mm</b>	<b>POLE</b>

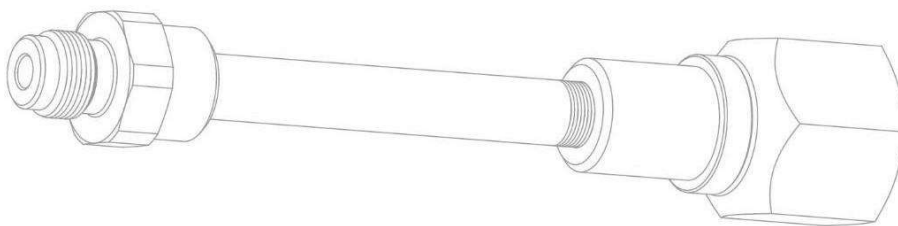

**DSTech Co., LTD.**  
#1461-2, Songjung-dong, Gangseo-gu,  
Busan, Korea (618-817)  
Tel: 82-51-207-8006  
Fax: 82-51-207-8831  
[www.dstpump.com](http://www.dstpump.com)

**S/W Tip GUARD**

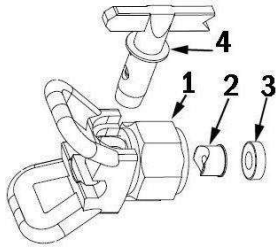

No	D Code	G Code	Description
1	AST0-001	237-859	7/8" S/W TIP GUARD
	AST0-002	237-858	11/16"S/W TIP GUARD
2	AST0-003		SADDLE
3	AST0-004		PACKING
4	AST0-XXX		S/W TIP

**GUN Adapter**

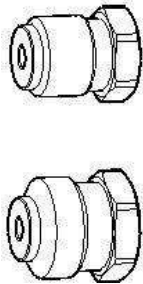

D Code	G Code	Description (IN)x(OUT)
E110-006		GUN ADAPTER (7/8")x (1/2-20)
E110-007		GUN ADAPTER (11/16")x (1/2-20)

**Turn Spary Nozzle**

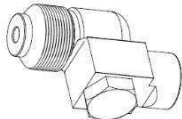

D Part	G Part	Description Inlet x Outlet
AGES-001	235-486	1/2"-20unf x 7/8"-14unc

**Extension Pol**

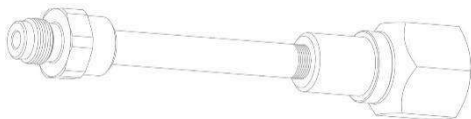

D Part	G Part	Description Inlet x Outlet
AGEB-K01		0.3M 7/8"-14unf x 1/2"-20unf
AGEB-K02		0.5M 7/8"-14unf x 1/2"-20unf
AGEB-K03		0.7M 7/8"-14unf x 1/2"-20unf
AGEB-N04		1.0M 7/8"-14unf x 1/2"-20unf

**Flat Tip HOUSING NUT**

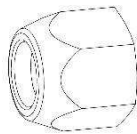

D Part	G Part	Description
G830-001	220-255	TIP FILLET HOUSING NUT

**Tip Filter Housing**

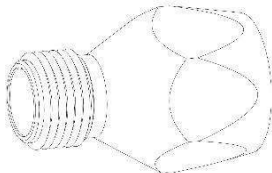

D Part	G Part	Description Inlet x Outlet
G830-004	164-120	7/8"-14unf x 11/16"-16unc

# **Gun Extension Pole and Accessories**

2015.09.21 rev3

**AGEB-001 3" POLE**  
**AGEB-002 6" POLE**  
**AGEB-003 9" POLE**

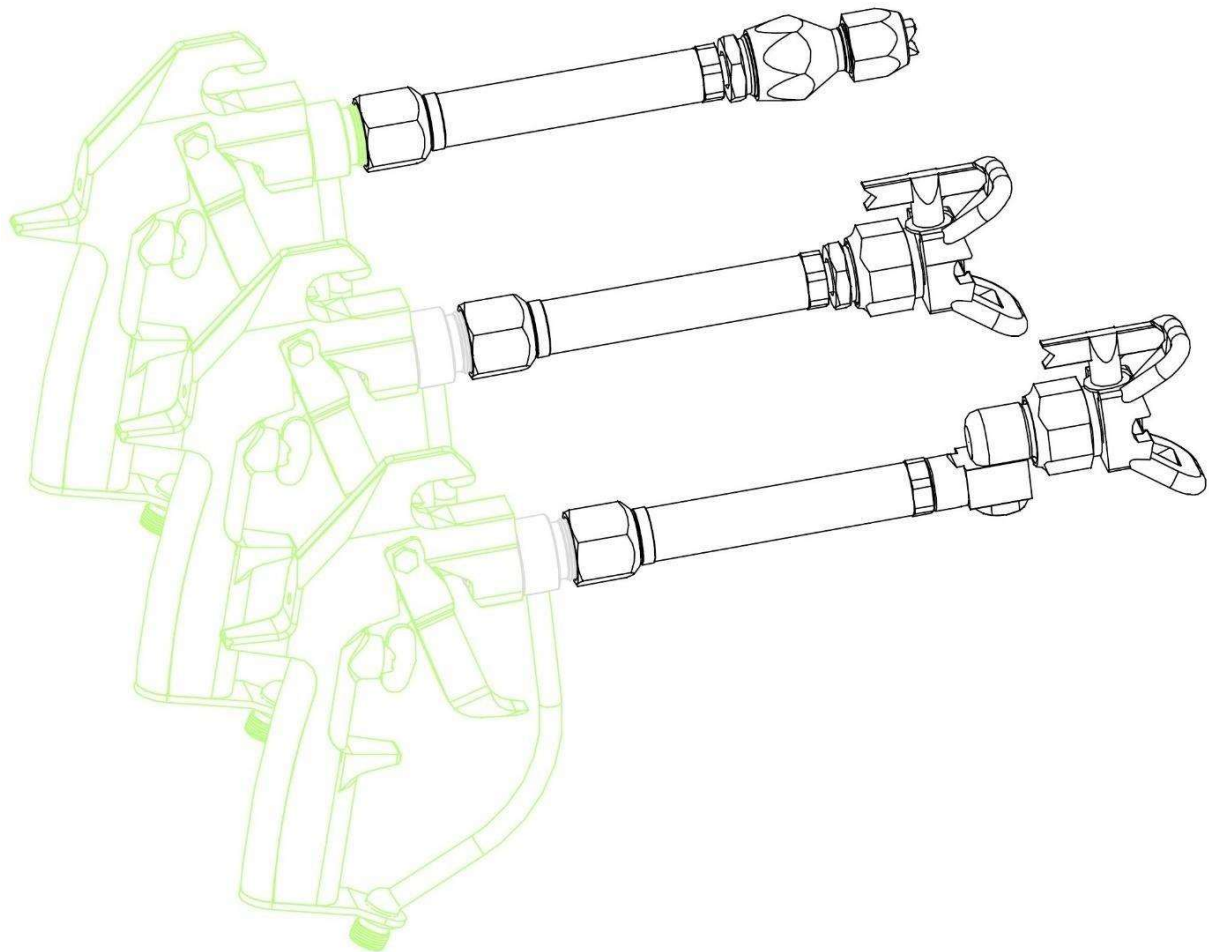

**DSTech Co., LTD.**  
#1461-2, Songjung-dong, Gangseo-gu,  
Busan, Korea (618-817)  
Tel: 82-51-207-8006  
Fax: 82-51-207-8831  
[www.dstpump.com](http://www.dstpump.com)

**S/W Tip GUARD**

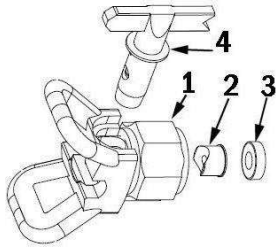

No	D Code	G Code	Description
1	AST0-001	237-859	7/8" S/W TIP GUARD
	AST0-002	237-858	11/16" S/W TIP GUARD
2	AST0-003		SADDLE
3	AST0-004		PACKING
4	AST0-XXX		S/W TIP

**GUN Adapter**

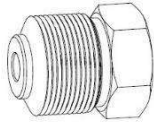

D Code	G Code	Description (IN)x(OUT)
AGA0-001	181-085	GUN ADAPTER (7/8")x (11/16")
AGA0-002		GUN ADAPTER (1/2")x (11/16")
AGA0-003		GUN ADAPTER M17P1.5x (11/16")

**Turn Spary Nozzle**

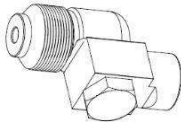

D Part	G Part	Description Inlet x Outlet
AGES-001	235-486	1/2"-20unf x 7/8"-14unc

**Extension Pol**

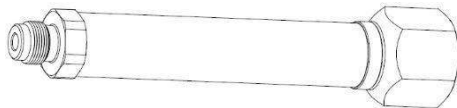

D Part	G Part	Description Inlet x Outlet
AGEB-001		3 feet 7/8"-14unf x 1/2"-20unf
AGEB-002		6 feet 7/8"-14unf x 1/2"-20unf
AGEB-003		9 feet 7/8"-14unf x 1/2"-20unf

**Extension Pol**

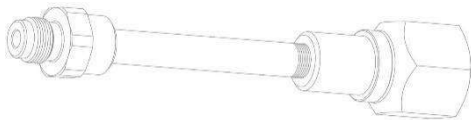

D Part	G Part	Description Inlet x Outlet
AGEB-N01		0.3M 7/8"-14unf x 1/2"-20unf
AGEB-N02		0.5M 7/8"-14unf x 1/2"-20unf
AGEB-N03		0.7M 7/8"-14unf x 1/2"-20unf
AGEB-N04		1.0M 7/8"-14unf x 1/2"-20unf

**Flat Tip HOUSING NUT**

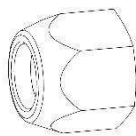

D Part	G Part	Description
G830-001	220-255	TIP FILLET HOUSING NUT

**Tip Filter Housing**

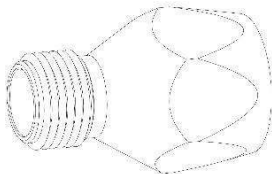

D Part	G Part	Description Inlet x Outlet
G830-004	164-120	7/8"-14unf x 11/16"-16unc

# POLE GUN

2015.09.21 rev8

## Forging Aluminum alloy Body

5000 psi (345 bar) Maximum Working Pressure    Fluid Inlet 1/4nps

### The Leather V-packing included with the gun

<b>Part No. G731-100 (237-768)</b>	1 feet	(300 mm) length
<b>Part No. G732-100 (237-769)</b>	2 feet	(600 mm) length
<b>Part No. G733-100 (205-129)</b>	3 feet	(910 mm) length
<b>Part No. G734-100 (237-770)</b>	4 feet	(1.2 m) length
<b>Part No. G735-100</b>	5 feet	(1.5 m) length
<b>Part No. G736-100 (204-979)</b>	6 feet	(1.8 m) length
<b>Part No. G738-100 (205-130)</b>	8 feet	(2.4 m) length

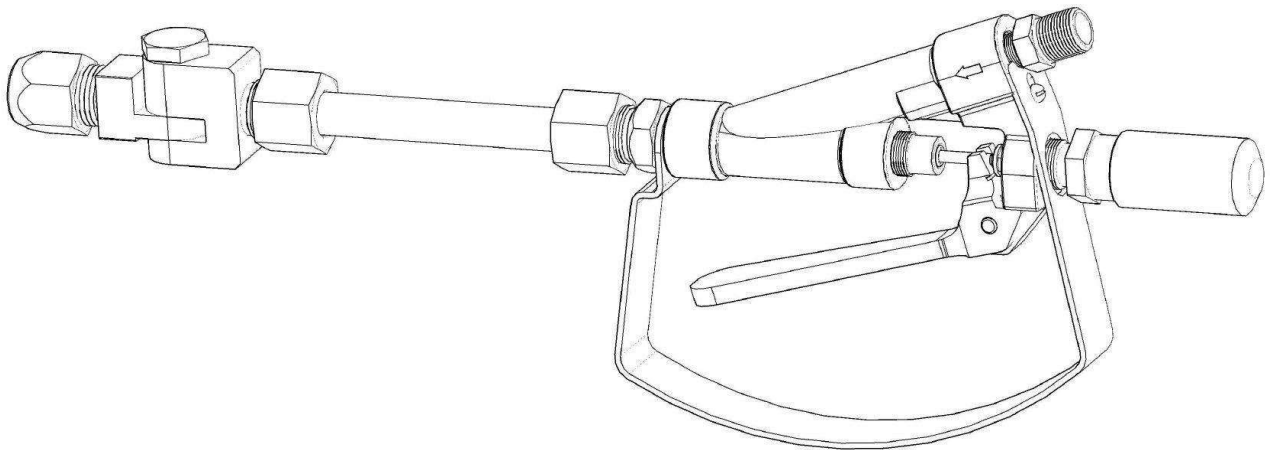

**DSTech Co., LTD.**  
#1461-2, Songjung-dong, Gangseo-gu,  
Busan, Korea (618-817)  
Tel: 82-51-207-8006  
Fax: 82-51-207-8831  
[www.dstpump.com](http://www.dstpump.com)

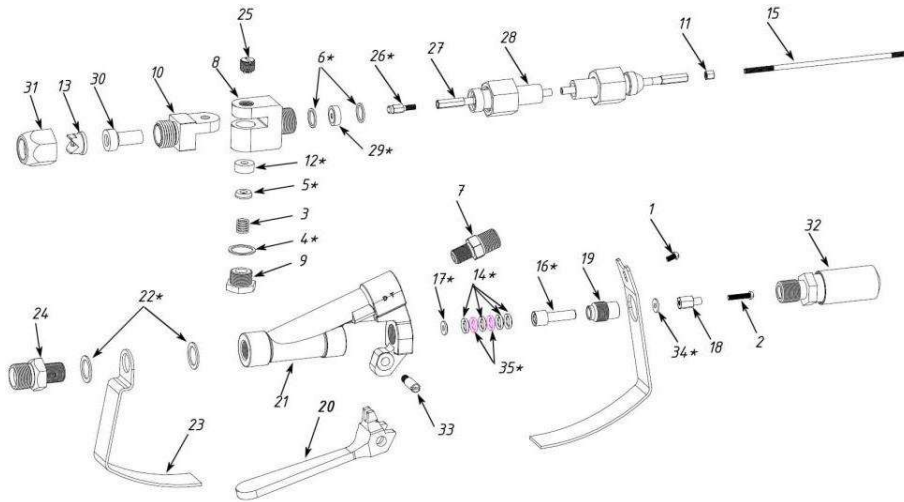

# Parts



**Note :** part marked in color are the Repair Kit parts **D part No G730-501**

No	Code	Description	Qty	No	Code	Description	Qty
1	G730-001	Screw	1	19	G730-019	SCREW	1
2	G730-002	Cap Screw	1	20	G730-120	HANDLE	1
3	G730-003	Spring	1	21	G730-121	BODY(AL)	1
4	G730-004	Gasket (copper)	1	22	G730-022	GASKET (copper)	2
5	G730-005	Washer	1	23	G730-023	GUARD	1
6	G730-006	Gasket (copper)	2	24	G730-024	ADAPTER	1
7	G730-007	Nipple	1	25	G730-025	SCREW	1
8	G730-008	HOUSING, swivel	1	26	G730-026	STEM. valve	1
9	G730-009	Plug	1	27		STEM, extension	1
10	G730-010	NOZZLE, swivel	1	28		TUBE, extension	1
11	G730-011	NUT	1	29	G730-029	SEAT	1
12	G730-012	SEAL,	1	30	ATOW-XXX	TIP FILTER	
14	G730-014	Packing(PTFE)	4	31	G730-031	TIP NUT	1
15	G730-015	ROD	1	32	G730-032	SAFETY KNOB	1
16	G730-016	GLAND (F)	1	33	G730-033	SCREW	1
17	G730-017	GLAND (M)	1	34	G730-034	WASHER	1
18	G730-018	NUT	1	35	G730-035	Packing(Leather)	2

STEM ,extension				TUBE ,extension			
No	D Code	Description	Qty	No	D Code	Description	Qty
27	G730-271	For model G731-000		28	G730-281	For model G731-000	
	G730-272	For model G732-000			G730-282	For model G732-000	
	G730-273	For model G733-000			G730-283	For model G733-000	
	G730-274	For model G734-000			G730-284	For model G734-000	
	G730-275	For model G735-000			G730-285	For model G735-000	
	G730-276	For model G736-000			G730-286	For model G736-000	
	G730-278	For model G738-000			G730-288	For model G738-000	

<p><b>POLE GUN NOZZLE</b></p> 	<table border="1"> <thead> <tr> <th>No</th> <th>D Code</th> <th>Description</th> </tr> </thead> <tbody> <tr> <td>1</td> <td>G730-600</td> <td>GUN NOZZLE</td> </tr> </tbody> </table>	No	D Code	Description	1	G730-600	GUN NOZZLE			
No	D Code	Description								
1	G730-600	GUN NOZZLE								
<p><b>SAFETY KNOB</b></p> 	<table border="1"> <thead> <tr> <th>No</th> <th>D Code</th> <th>Description</th> </tr> </thead> <tbody> <tr> <td>1</td> <td>G730-032</td> <td>350 BAR SAFETY KNOB</td> </tr> <tr> <td>2</td> <td>G730-042</td> <td>250 BAR SAFETY KNOB</td> </tr> </tbody> </table>	No	D Code	Description	1	G730-032	350 BAR SAFETY KNOB	2	G730-042	250 BAR SAFETY KNOB
No	D Code	Description								
1	G730-032	350 BAR SAFETY KNOB								
2	G730-042	250 BAR SAFETY KNOB								